

**FRF** 1.6MPa(16bar)

## 油箱顶置回油过滤器 Tank-Top return Filters



R1



R2

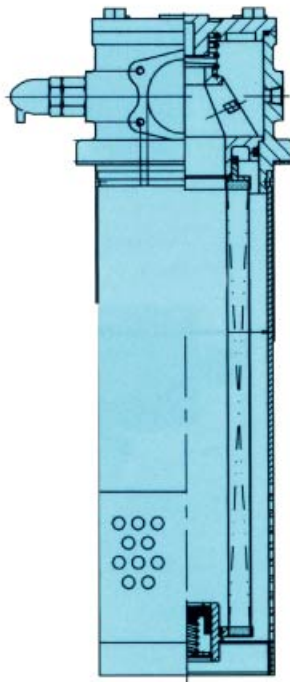

### 材料

壳体: 铝合金

滤芯: 玻纤, 滤纸和编织网

### 压力 (ISO 10771-1:2002)

最大工作压力: 1.6 MPa (16 bar)

试验压力: 3.2 MPa (32 bar)

爆破压力: 4.8 MPa (48 bar)

标准滤芯爆破压力: 1MPa (10bar)

旁通阀开启压力: 400 kPa (4 bar) +/-10%

指示器发讯压力: 350Kpa (3.5bar) +/-10%

### 工作温度:

-25° to +110° C

### MATERIALS

Housing: Aluminium Alloy

Element: Inorganic Fibers, Paper, Wire Mesh h

### PRESSURE (ISO 10771-1:2002)

Max. working: 1.6 MPa (16 bar)

Test: 3.2 MPa (32 bar)

Bursting: 4.8 MPa (48 bar)

Collapse, differential for the filter element

(ISO 2941): 1MPa (10 bar)

Bypass Valve: Setting 400KPa(4bar) +/-10%

Switch: Setting 350KPa(3.5bar) +/-10%

### WORKING TEMPERATURE:

From -25° to +110° C

外廓尺寸(mm)  
DIMENSIONAL LAYOUT

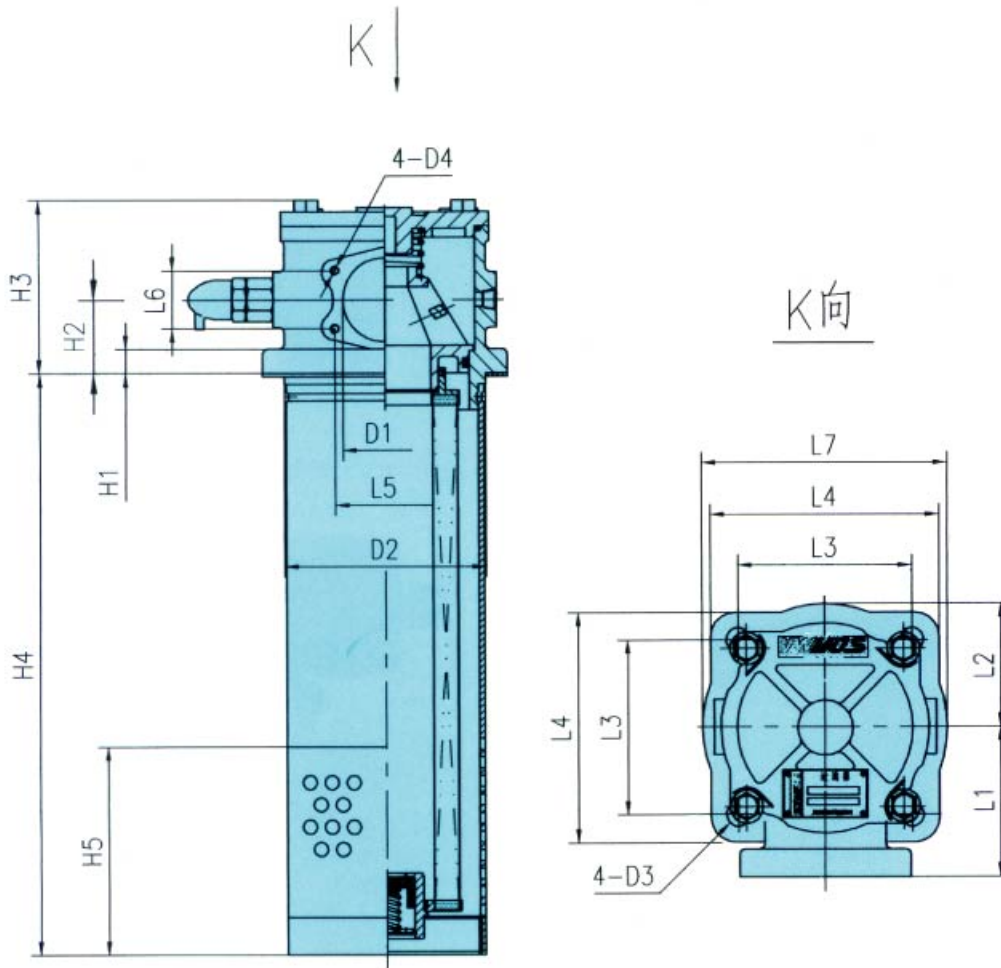

Type 型号	D1	D2	D3	D4	H1	H2	H3	H4	H5	L1	L2	L3	L4	L5	L6	L7	焊管外径 Q
FRF063	G1	φ95	φ9	--	13	33	93	185	60	60	53	85	110	--	--	φ120	--
	M33×2							245									
FRF100	G1 1/4	φ110	φ13	M10	15	40	102	319	80	85	67	95	125	--	--	φ134	φ57
	M42×2							419									
FRF160	φ50	φ130	φ13	M10	15	55	127	463	90	90	79	110	140	77.8	42.9	φ158	φ65
FRF250	φ65							594									
FRF400	φ90	φ160	φ13	M10	15	70	164	456	100	110	96	140	170	106.4	62	φ192	φ102
FRF500	484																
FRF630	594																
FRF800								774									
FRF1000																	

注:本产品配套提供进油口SAE法兰,用户需要准备外径φQ的管子用于焊接.

Note:the input flange of this series will be supplied by our plant,The user needs to prepare weld steel tube φ Q only.

过滤器总成的压降等于壳体的压降加上清洁滤芯的压降。在选择流量时，过滤器的阻力最好小于50KPa(0.5bar)。

The "Assembly Pressure Drop ( $\Delta P$ )" is obtained by adding the pressure drop values of the Filter Housing and of the Clean Filter Element corresponding to the considered Flow Rate and it must be lower than 50KPa(0.5bar).

### 过滤器壳体压降 Filter Housing Pressure Drop

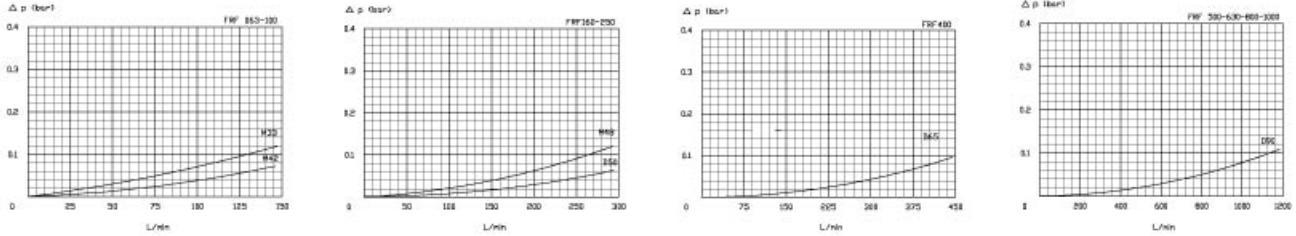

### 清洁滤芯压降 (滤材: 玻纤, 滤纸) Clean Filter Element Pressure Drop with Fiber and Paper

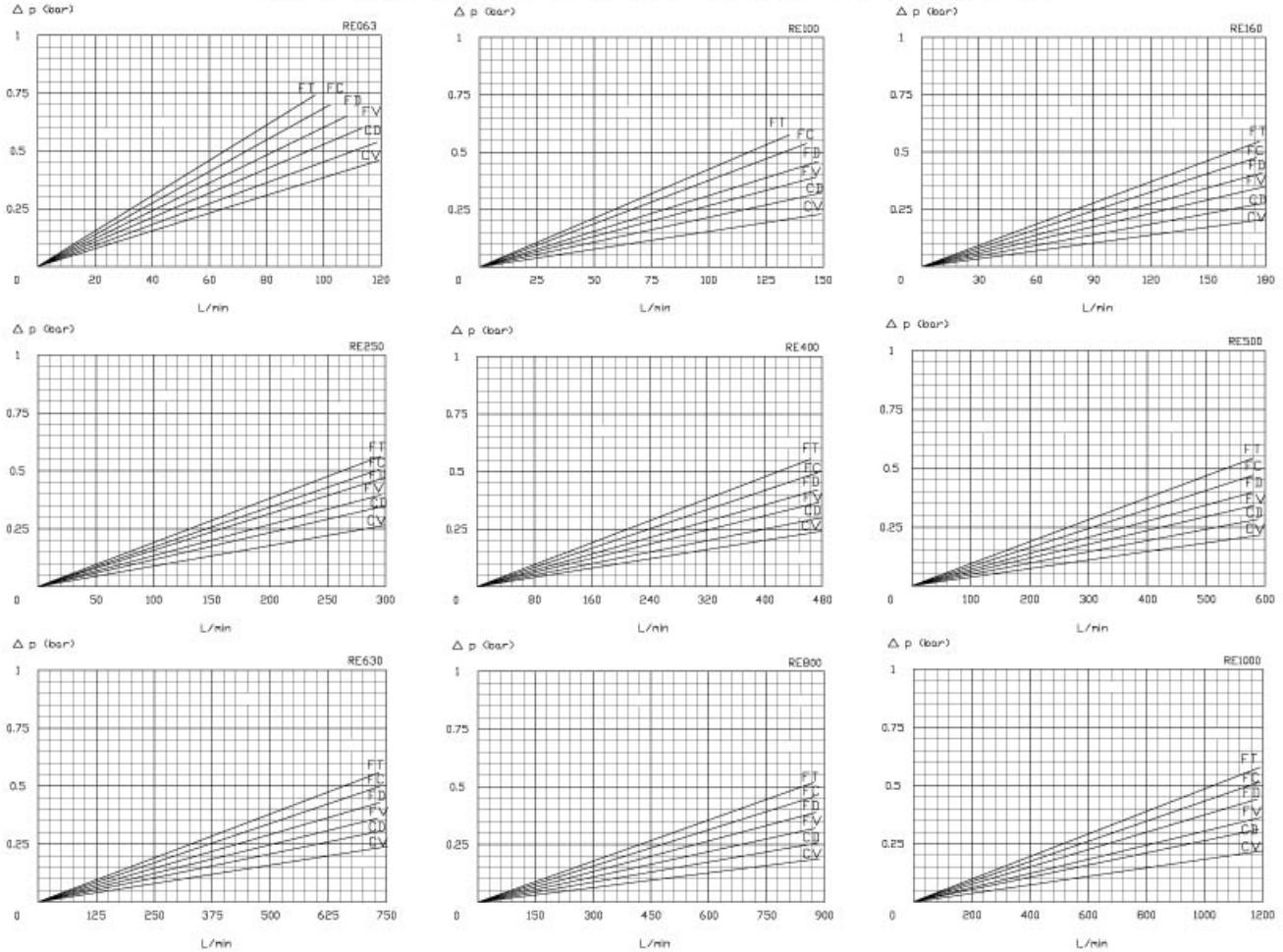

所有压降曲线是在动力粘度30cSt、密度0.9条件下，按ISO 3968:2005由矿物油试验得到。

N.B. All the curves have been obtained with mineral oil having a kinematic viscosity 30cSt and specific gravity 0,9; according to the specification ISO 3968:2005.

如何选购过滤器  
How to order the completed filter

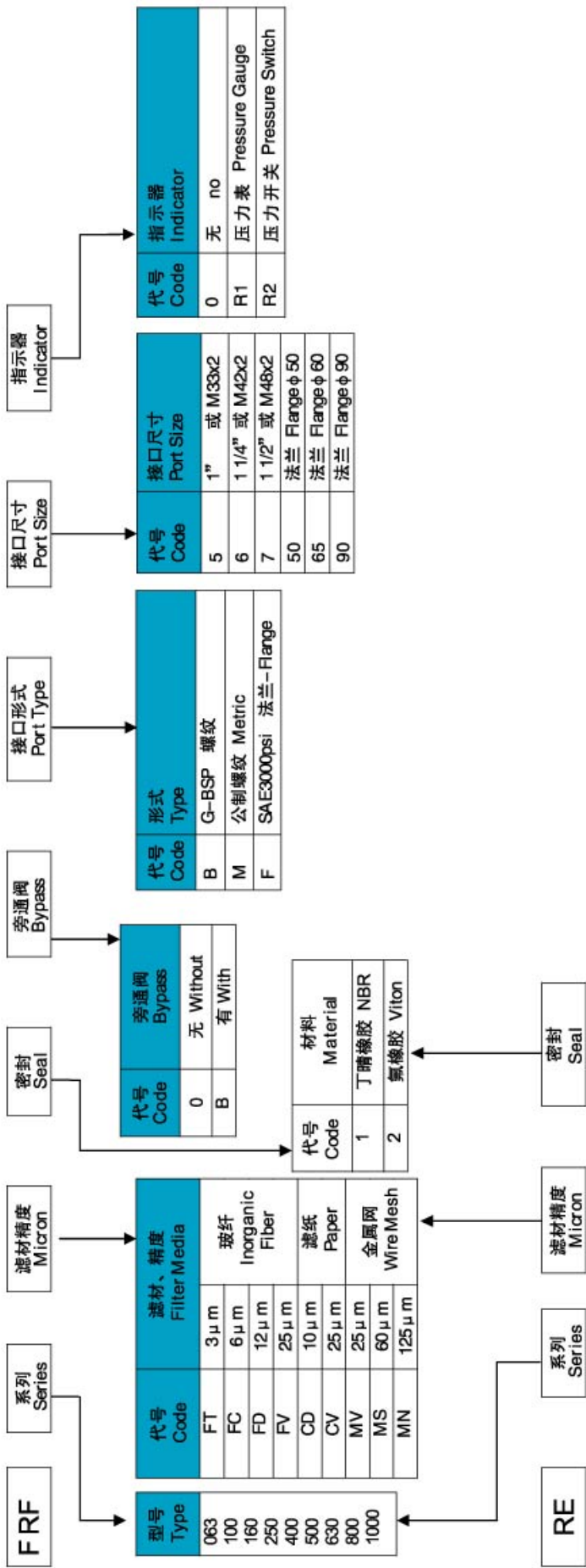

如何选购滤芯  
How to order the filter element