



MDM 11MPa(110bar)

中压管路过滤器

Medium Pressure Inline Filters



52



72

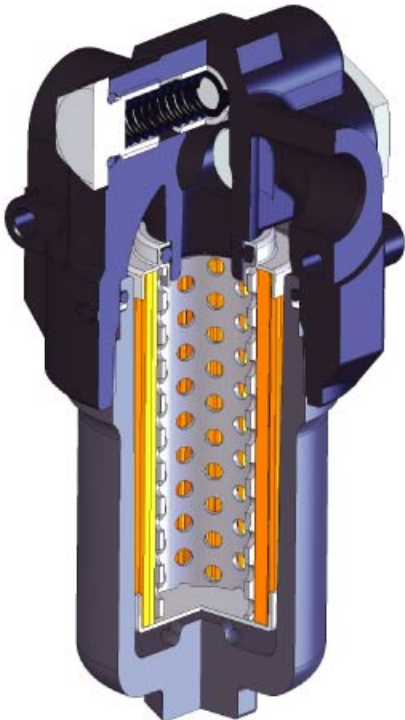

材料

壳 体: 铝合金

滤 芯: 玻纤, 滤纸, 编织网

密 封: 丁晴橡胶

压力 (ISO 10771-1:2002)

最大工作压力: 11 MPa (110 bar)

试验压力: 16 MPa (160 bar)

爆破压力: 30 MPa (300 bar)

滤芯爆破压力: 8 MPa (80 bar)

旁通阀: 600 kPa (6 bar) +/-10%

工作温度: -25° to +110° C

MATERIALS

Housing: Anodized aluminium alloy

Bypass valve: Brass

Seals: NBR Nitrile

PRESSURE (ISO 10771-1:2002)

Max working: 11 MPa (110 bar)

Test: 16 MPa (160 bar)

Bursting: 30 MPa (300 bar)

Collapse, differential for the filter element (ISO 2941): 8 MPa (80 bar)

BYPASS VALVE

Setting: 600 kPa (6 bar) +/-10%

WORKING TEMPERATURE

From -25° to +110° C

外廓尺寸
DIMENSIONAL LAYOUT

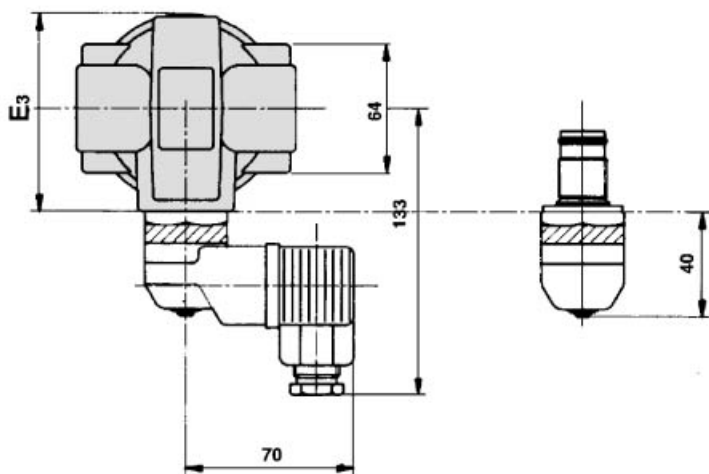
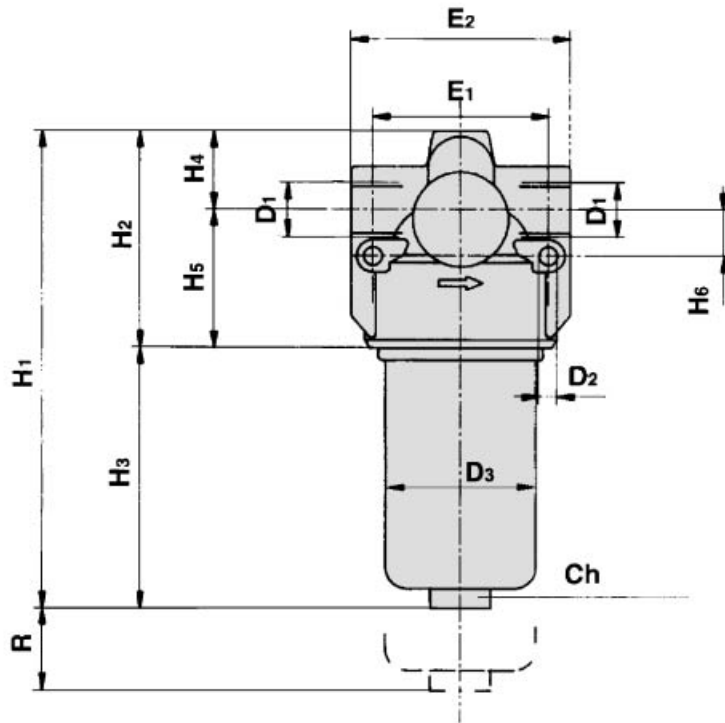

尺寸 (mm) 与重量 (Kg)
DIMENSIONS (mm) AND WEIGHTS (Kg)

型号 Type	D			H						E			R	Ch	Kg	
	1	2	3	1	2	3	4	5	6	1	2	3				
MDM 101	1/2"			157		79					64	76	75	60	22	0,65
MDM 102	M18×1.5	6.5	55	244	78	166	28	50	17		64	76	75	60	22	0,85
MDM 201	1"			221		121					94	114	92	56	25	1,85
MDM 202	M33×2	8.5	86	277	100	177	37	63	24		94	114	92	56	25	2,15

过滤器总成的压降等于壳体的压降加上清洁滤芯的压降。在选择流量时，过滤器的阻力最好小于80KPa(0.8bar)。

The "Assembly Pressure Drop (ΔP)" is obtained by adding the pressure drop values of the Filter Housing and of the Clean Filter Element corresponding to the considered Flow Rate and it must be lower than 80KPa(0.8bar).

过滤器壳体压降 Filter Housing Pressure Drop

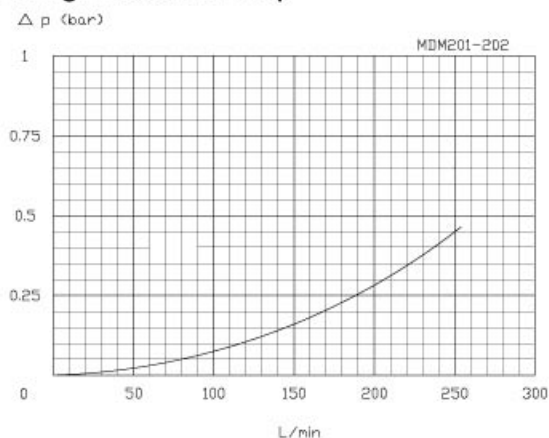
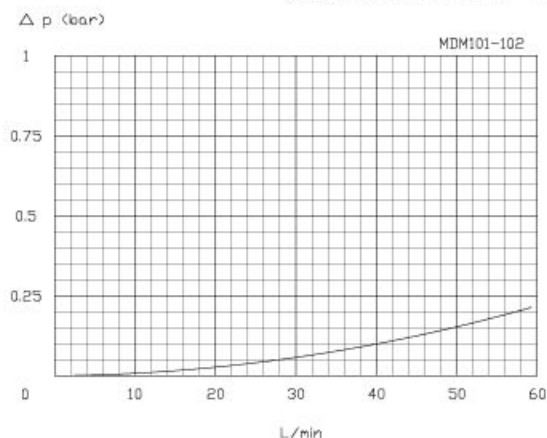

清洁滤芯压降 (滤材: 玻纤和纸)

Clean Filter Element Pressure Drop with F + and C+ Media

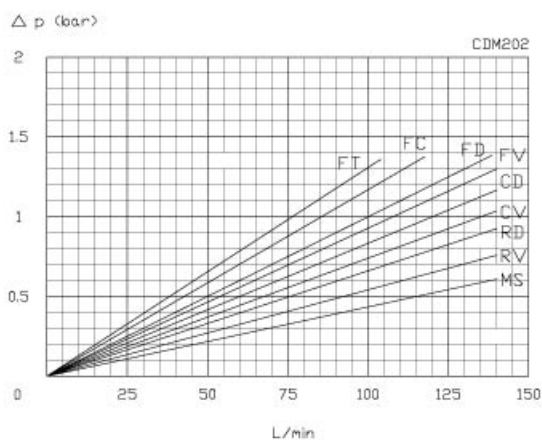
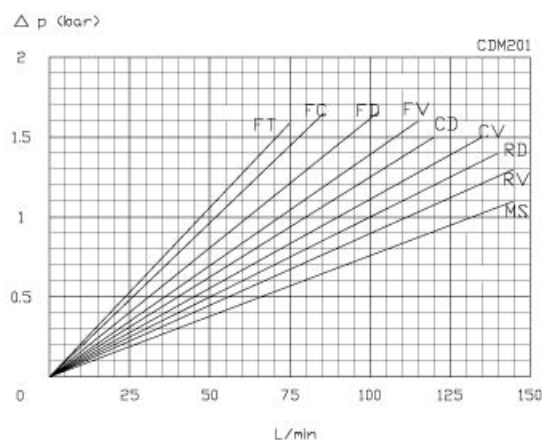
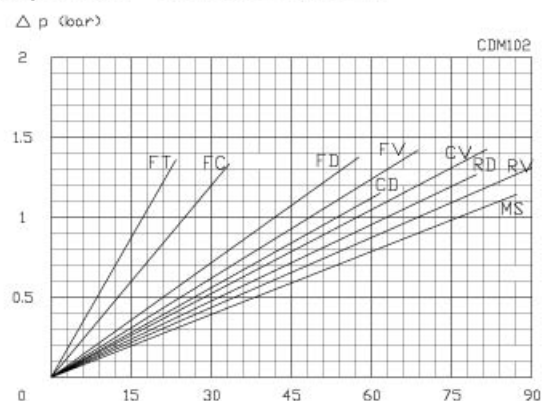
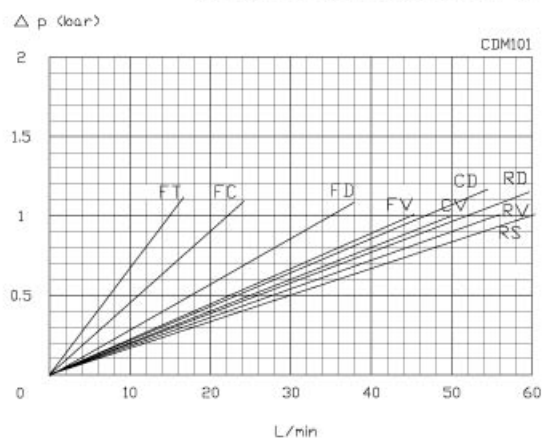

所有压降曲线是在动力粘度30cSt、密度0.9条件下，按ISO 3968:2005由矿物油试验得到。

N.B. All the curves have been obtained with mineral oil having a kinematic viscosity 30cSt and specific gravity 0,9; according to the specification ISO 3968:2005.

如何选购过滤器

How to order the completed filter

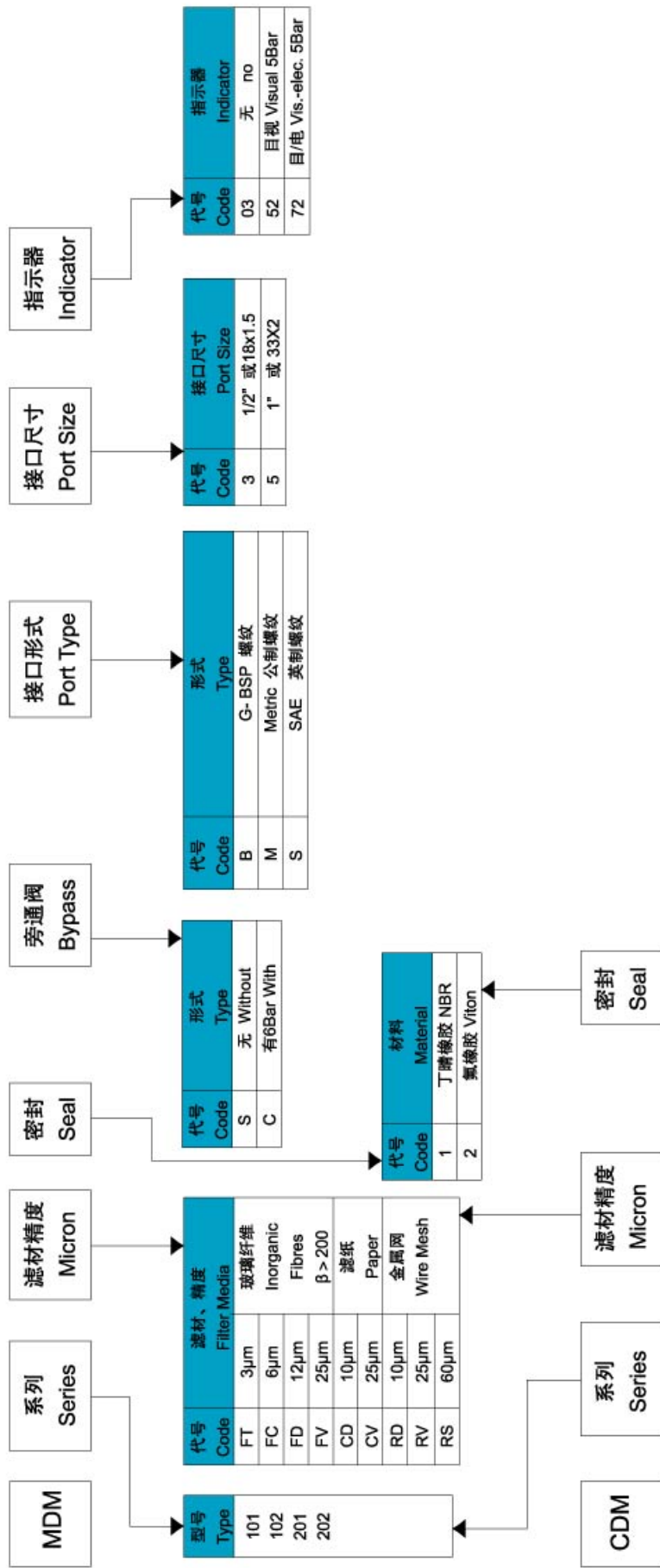

如何选购滤芯

How to order the filter element