

RFA 700KPa(7bar)

油箱顶置式回油过滤器 Tank-Top Return Filters



32



30



材料

滤头: 铝

下壳体 and 顶盖: 聚酰胺

滤 芯: 玻纤, 滤纸, 金属网

压力 (ISO 10771-1:2002)

工作压力: 700KPa(7bar)

滤芯爆破压力: 300KPa (3bar)

旁通阀设置: 170 kPa (1.7 bar) +/-10%

工作温度: -25° to +110° C

MATERIALS

Head: Aluminium Alloy

Bowl & Cover: Polyamide

Element: Inorganic Fibers, Paper, Wire Mesh

PRESSURE (ISO 10771-1:2002)

Max working: 700KPa(7bar)

Collapse, differential for the filter element:

300KPa (3 bar)

BYPASS VALVE: Setting: 170 kPa (1.7bar) +/-10%

WORKING TEMPERATURE:

From -25° to +110° C

外廓尺寸
DIMENSIONAL LAYOUT

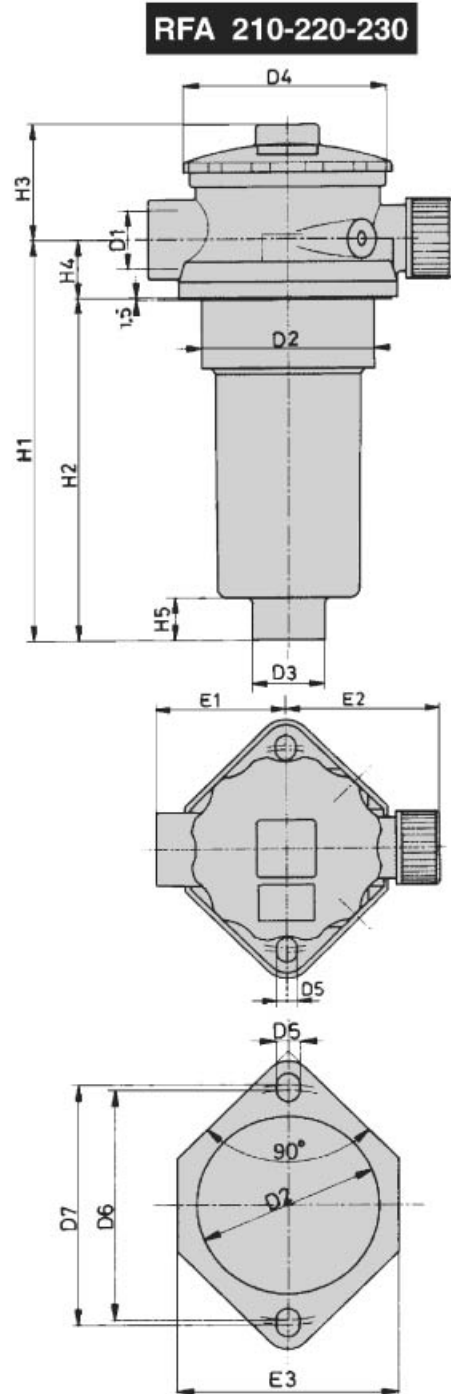
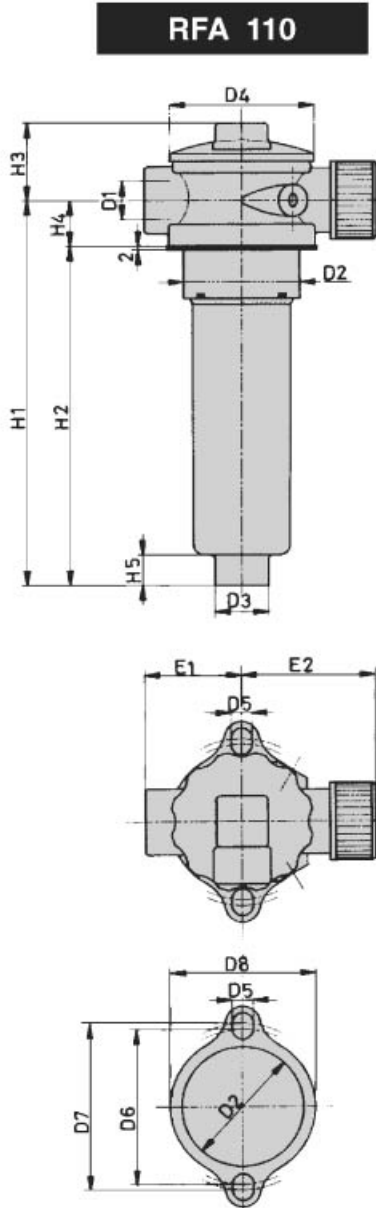

尺寸 (mm)
DIMENSIONS (mm)

型号 Type	D1	D2	D3	D4	D5	D6	D7	D8	H1	H2	H3	H4	H5	E1	E2	E3
RFA 110..	1/2" 3/4"	min. 60 min. 63	28	75	11	82	88	77	202	178	41	24	16	50	70	-
RFA 210..	3/4" 1"	min. 87 min. 91	36	104	11	110	115	-	140	110	60	30	22	70	83	103
RFA 220..			36	104	11	110	115	-	205	175	60	30	22	70	83	103
RFA 230..			36	104	11	110	115	-	305	275	60	30	22	70	83	103
RFA 310..	1 1/4"	85	40		9		116	-		225	98.2	34	25	68	77	

过滤器总成的压降等于壳体的压降加上清洁滤芯的压降。在选择流量时，过滤器的阻力最好小于50KPa(0.5bar)。

The "Assembly Pressure Drop (ΔP)" is obtained by adding the pressure drop values of the Filter Housing and of the Clean Filter Element corresponding to the considered Flow Rate and it must be lower than 50KPa(0.5bar).

过滤器壳体压降 Filter Housing Pressure Drop

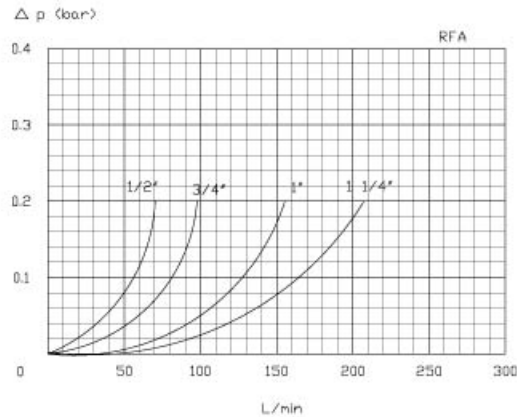

清洁滤芯压降 (玻纤, 纸和金属网)

Clean Filter Element Pressure Drop with F + and C+ MS

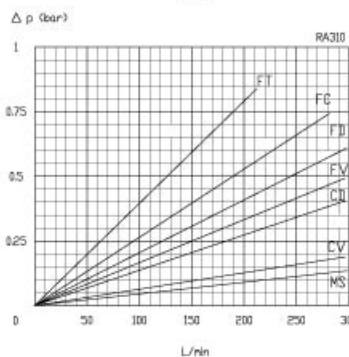
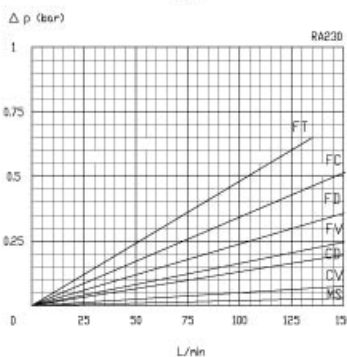
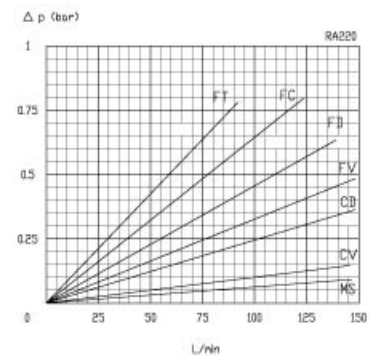
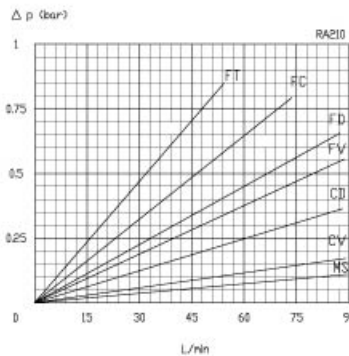
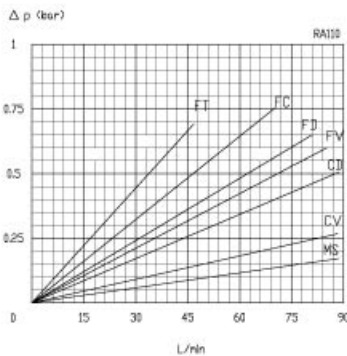

所有压降曲线是在动力粘度30cSt、密度0.9条件下，按ISO 3968:2005由矿物油试验得到。

N.B. All the curves have been obtained with mineral oil having a kinematic viscosity 30cSt and specific gravity 0,9; according to the specification ISO 3968:2005.

如何选购过滤器
How to order the completed filter

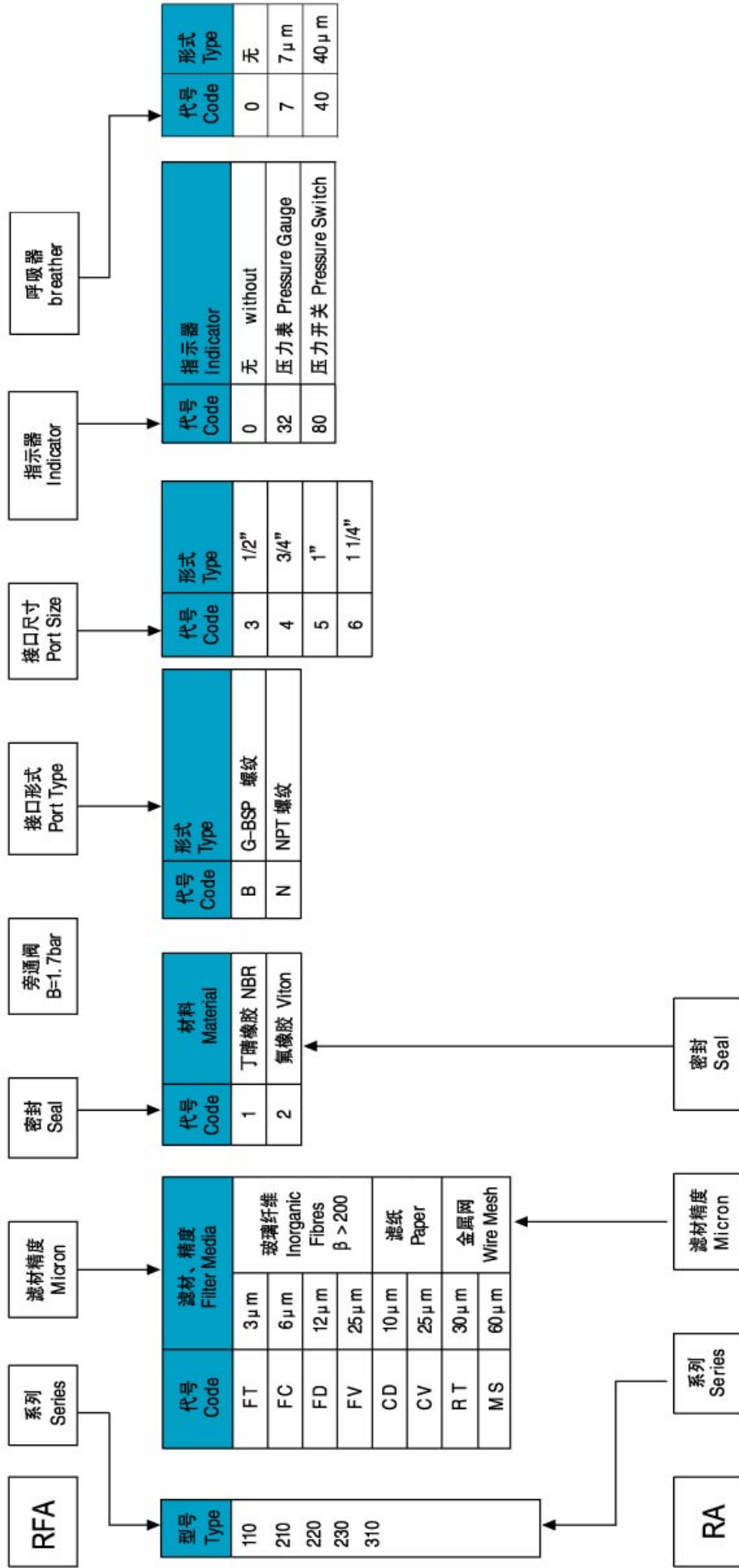

如何选购滤芯
How to order the filter element